

2060 SERIES

For Manual and Automated Wiring Systems

- Low profile: 4.5 mm
- Pin spacing: 4 mm
- Conductor range: 0.2 ... 0.75 mm² (24 ... 18 AWG)
- Insert solid conductors via push-in termination
- Push-buttons simplify insertion/removal of all conductor types
- Available in 1- to 3-pole configurations
- Side-by-side assembly without pole loss
- Available in tape-and-reel packaging

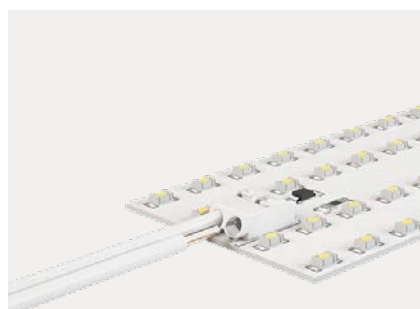

Push-in termination of solid conductors

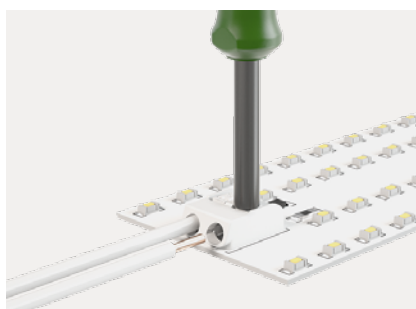

Insert/remove fine-stranded conductors by lightly pressing on a push-button, e.g., via operating tool (206-860).



2060 Series, 4 mm Pin Spacing				
Pin spacing	4 mm / 0.157 inch			Conductor Data
Ratings per	IEC/EN 60664-1			Connection technology
Overvoltage category	III	III	II	Push-in CAGE CLAMP®
Pollution degree	3	2	2	Conductor range: solid
Rated voltage	63 V	160 V	320 V	0.2 ... 0.75 mm ²
Rated surge voltage	2.5 kV	2.5 kV	2.5 kV	Conductor range: fine-stranded
Rated current	9 A	9 A	9 A	0.2 ... 0.75 mm ²
Approvals per	UL 1977			Conductor range: fine-stranded
Rated voltage, 1-pole	600 V			0.25 ... 0.34 mm ² (with insulated ferrule)
Rated voltage, 2 or more poles	320 V			Conductor range: fine-stranded
Nominal current UL	9 A			0.25 ... 0.34 mm ² (with uninsulated ferrule)
Pole No.	Item No.	Pack. Unit	Strip length	AWG
			7 ... 9 mm / 0.28 ... 0.35 inch	24 ... 18
SMD PCB terminal blocks with push-buttons in tape-and-reel packaging, white				Reel diameter: 330 mm
1	2060-451/998-404	13500 (9 x 1500)		
2	2060-452/998-404	9000 (9 x 1000)		
3	2060-453/998-404	6750 (9 x 750)		

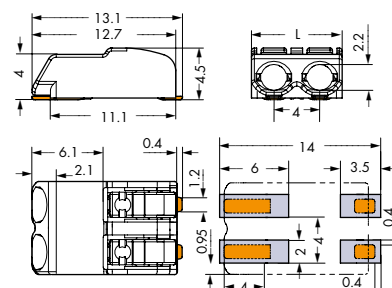

L = (pole no. x pin spacing) – 0.1 mm

2060 SERIES

Pin Spacing: 8 mm

The 2-pole SMD PCB terminal block with 8 mm pin spacing has joined WAGO's portfolio, providing higher rated voltages up to 630 V/6 kV/2 in LED and industrial applications.

Board-to-Board Link

Besides standard wiring, several LED modules can be easily assembled into a single string using board-to-board links. This minimizes labor (no manual wiring) and materials needed for connecting LED modules.

THR and Wave Soldering

WAGO's 2060 Series THR PCB Terminal Blocks with soldering pins are ideal for both THR and wave soldering. The 2060 THR Series is available in both white and black housings. Additional information at: www.wago.com/2060



Assembly: Place PCBs on a flat surface and connect terminal blocks on adjoining PCBs via board-to-board link.
Disassembly: Pull PCBs apart (max. 10 mating cycles). The PCBs must be secured.

2060 Series, Board-to-Board Link						
Pin spacing	4 mm / 0.157 inch			Pole No.	Item No.	Pack. Unit
Ratings per	IEC/EN 60664-1			1	2060-951/028-000	1500
Overvoltage category	III	III	II	2	2060-952/028-000	500
Pollution degree	3	2	2	3	2060-953/028-000	375
Rated voltage	63 V	160 V	320 V			
Rated surge voltage	2.5 kV	2.5 kV	2.5 kV	Note: Only suitable for 2060-45x, not for 2060-40x		
Rated current	9 A	9 A	9 A			

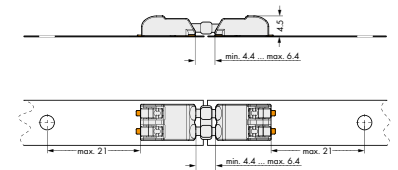

2060 Series, 8 mm Pin Spacing					
Pin spacing	8 mm / 0.314 inch			Conductor Data	
Ratings per	IEC/EN 60664-1			Connection technology	Push-in CAGE CLAMP®
Overvoltage category	III	III	II	Conductor range: solid	0.2 ... 0.75 mm ²
Pollution degree	3	2	2	Conductor range: fine-stranded	0.2 ... 0.75 mm ²
Rated voltage	400 V	630 V	1000 V	Conductor range: fine-stranded (with insulated ferrule)	0.25 ... 0.34 mm ²
Rated surge voltage	6 kV	6 kV	6 kV	Conductor range: fine-stranded (with uninsulated ferrule)	0.25 ... 0.34 mm ²
Rated current	9 A	9 A	9 A	AWG	24 ... 18
Approvals per	UL 1977			Strip length	7 ... 9 mm / 0.28 ... 0.35 inch
Rated voltage	600 V				
Nominal current UL	9 A				
Pole No.	Item No.			Pack. Unit	
SMD PCB terminal blocks with push-buttons in tape-and-reel packaging, white					Reel diameter: 330 mm
2	2060-852/998-404			6750 (9 x 750)	

