

Compact Splicing Connectors for Flexible Conductors 222 Series

CAGE CLAMP®

12

519

0.08-2.5 mm ² "s+f-st" 0.08-4 mm ² "f-st" 400 V/4 kV/2 ① I _N 32 A 9 - 10 mm / 0.37 in ②	AWG28-14 "s+f-st" AWG28-12 "f-st" 600 V, 20 A.Ⓜ-	0.08-2.5 mm ² "s+f-st" 0.08-4 mm ² "f-st" 400 V/4 kV/2 ① I _N 32 A 9 - 10 mm / 0.37 in ②	AWG28-14 "s+f-st" AWG28-12 "f-st" 600 V, 20 A.Ⓜ-
--	--	--	--



- ① in grounded power lines
400 V = rated voltage
4 kV = rated surge voltage
2 = pollution degree
(also see Section 14)
- ② Strip length, see packaging or instructions.

Color	Item No.	Pack. Unit	Color	Item No.	Pack. Unit
Compact splicing connector, 2-conductor connector, with levers, max. continuous service temperature 85 °C ● gray			Compact splicing connector, 3-conductor connector, with levers, max. continuous service temperature 85 °C ● gray		
	222-412	500 (10x50)		222-413	500 (10x50)

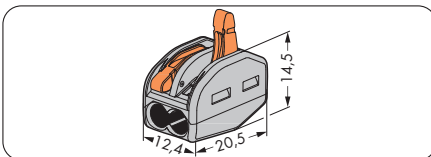

Dimensions in mm

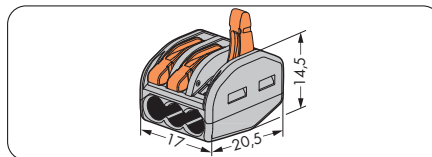

Dimensions in mm



Compact splicing connectors

Tool-free connection of up to 5 stripped fine-stranded conductors from 0.08 to 4 mm²/AWG 28 - 12, solid or stranded conductors up to 2.5 mm²/AWG 14.

This is how it works:

Open the clamping unit using the integrated orange lever actuator so that the lever engages and keeps the clamp in its opened position. The conductor can now be inserted, then the lever can be returned to its rest position, flush with the connector housing.

The safety:

The specially designed rest position of the lever reliably prevents accidental unclamping of a connected conductor. Application safety, for any type of conductor (solid, stranded, fine-stranded), is confirmed by approvals like ENEC and UL.

ENEC is the European mark for electrical products that demonstrates compliance with European safety standards. The ENEC mark is subjected to the same EN standards as the VDE mark.

While the VDE mark is only permitted in Germany, the ENEC mark is accepted in more than 20 European countries.



Color	Item No.	Pack. Unit
Compact splicing connector, 5-conductor connector, with levers, max. continuous service temperature 85 °C ● gray		
	222-415	400 (10x40)
Dimensions in mm		

For list of approvals and user guide, see pages 634 to 637.

12

Types of Assembly Mounting Carrier 222 Series



Horizontal mounting on DIN 35 rail using angled DIN-rail adapter.



Horizontal mounting with strain relief plate on DIN 35 rail using angled DIN-rail adapter.

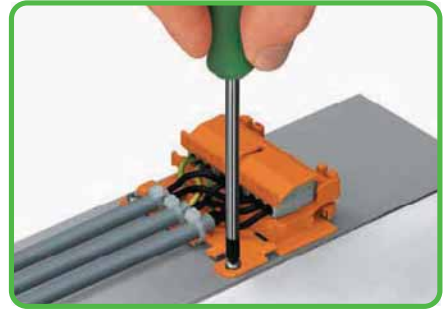

Horizontal mounting with strain relief plate on level surfaces.



Vertical mounting with strain relief plate on DIN 35 rail. Marking clamping units via marker strips.



Strain relief by cable tie on the carrier, transverse to the connector's wiring direction. Molded marking clamping units.

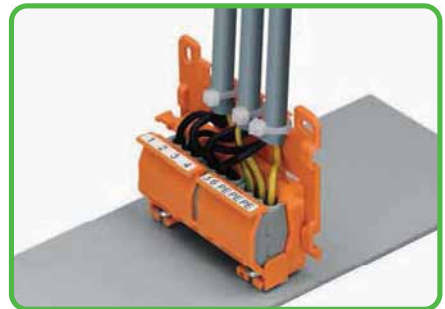

Mounting carrier with strain relief plate mounted vertically on a plate. Round cable fixed via strain relief lug.



Snapping of lateral connector safety lock.



Mounting of strain relief plate to the mounting carrier.

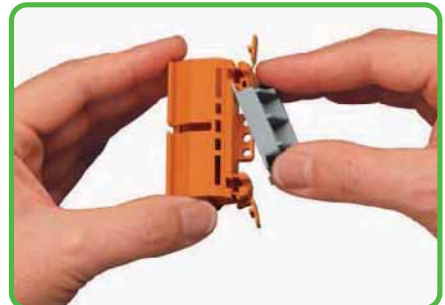

Snapping the angled DIN-rail adapter on the mounting carrier.



Testing connectors via test slots on top of the carrier.

